

 **samet**

sliding
DOOR SYSTEMS



NEW

SMT 100

Upper Guided Sliding Door System

- Easy assembly and disassembly opportunity
- 80 kg carrying capacity
- Compact and light design
- Suitable for different cover thicknesses with adjustable external and internal cover mechanism
- High quality bearing wheels
- Custom wheel material for silent functioning
- Suitable for cover thickness up from 18 mm up to 50 mm
- Locking item is used for stability
- Suitable hole sizes for mass production
- Small and elegant brake design
- 20 mm inner top mechanism adjustment feature

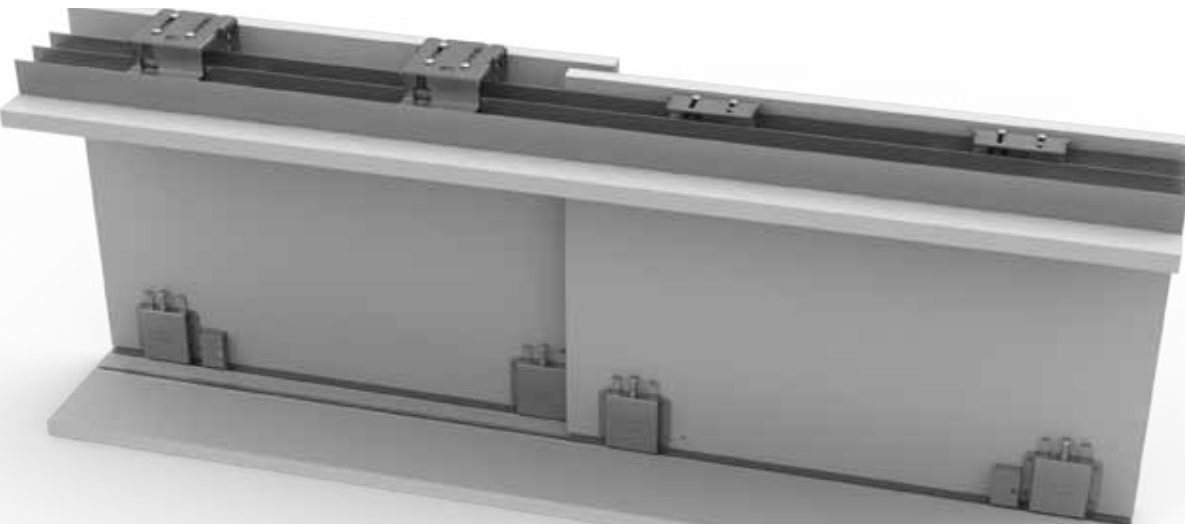

Packaging

Product is sold as a set.

- A set suitable for 2-door cabinets.
- Soft-Close mechanism is included in set.
- There are 10 sets in a package.
- Upper rail operates with double lower rail

Standard Set Includes



Aluminium Upper and Lower Rails



Mechanisms

DESCRIPTION	CODE	UNIT
SMT100 Upper Guided Sliding Door System	128009100	Set

Upper Rails

DESCRIPTION	CODE	LENGTH
SMT 100 Aluminium Upper Rail	1280185711250	2500 mm
SMT 100 Aluminium Upper Rail	1280185711300	3000 mm

Lower Rails

DESCRIPTION	CODE	LENGTH
60/75/80 kg Aluminium Single Female Lower Rail	1280184411250	2500 mm
60/75/80 kg Aluminium Single Female Lower Rail	1280184411300	3000 mm
75KG Aluminium Single Female Lower Rail	128018471250	2500 mm
75KG Aluminium Single Female Lower Rail	128018471300	3000 mm

Space Requirement in Cabinet

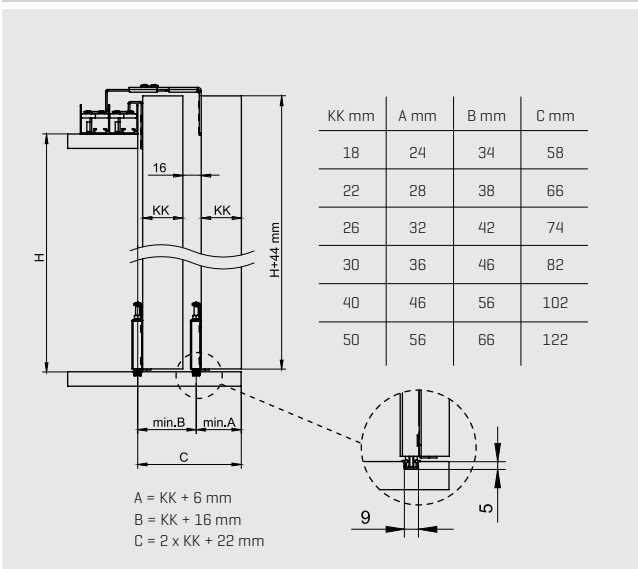

Bottom Rail Assembly and Fixing

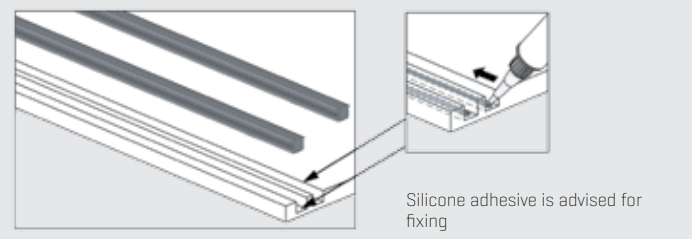

Application Features

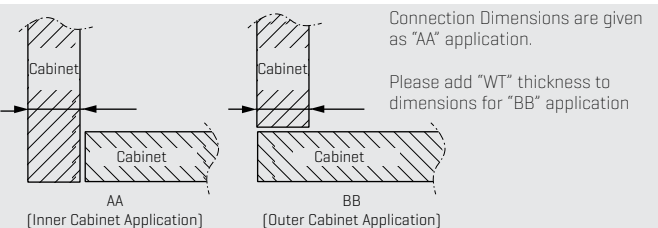

Mechanism Assembly

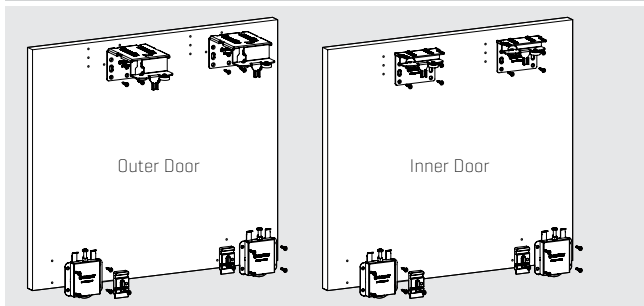

Door Installation and Adjustment

Inner Door Assembly

Outer Door Assembly

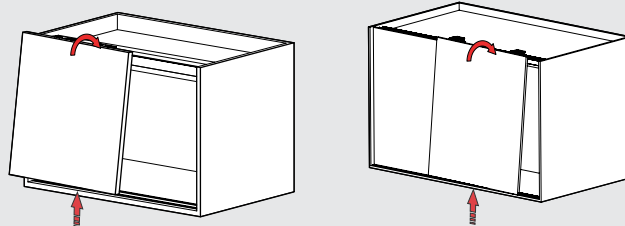

Space Requirement in Cabinet

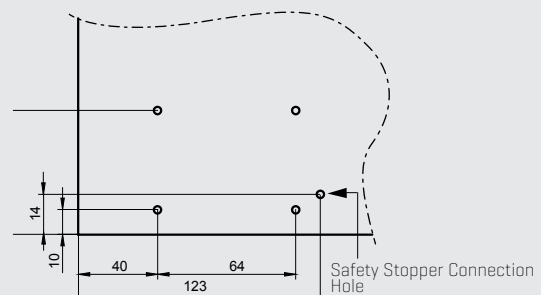
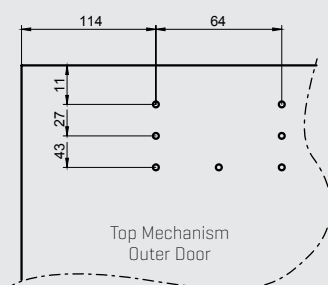
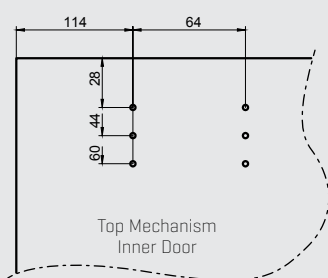

Loading Capacity for One Door : max. 80 kg

Safety Stopper Assembly

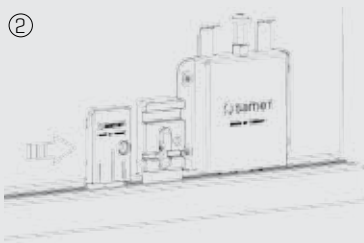
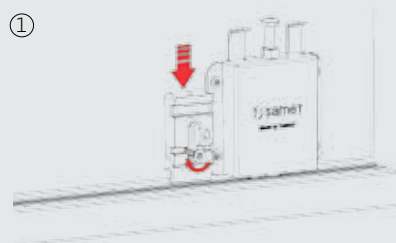

* Doors should be balanced before the assembly of stopper.

Adjustment Feature

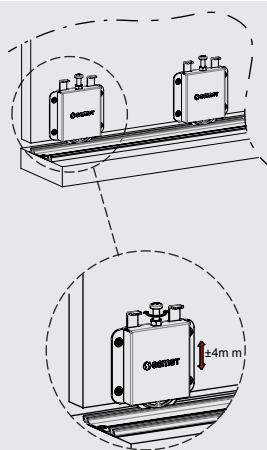

Soft-Close Mechanism

